

## 35OS SERIES 3,5" OIL-FILLED SUBMERSIBLE MOTORS

- The state-of-art design and choice of component materials ensure optimum operating performances, superior quality, reliability and ease of installation.

### SPECIFICATIONS

- Rewindable stator.
- Winding insulation: Class F .
- Protection grade: IP68.
- Filling fluid in compliance with standards concerning oils contact with foodstuffs and with the purity requirements specified by the annex to G.U. no. 104 of 20/04/1973; it also complies with F.D.A. (FOOD AND DRUG ADMINISTRATION) standards.
- Large compensation bellows for the expansion of the internal liquid.
- Oversized thrust bearings: Shaft supported by oversized angular bearings which can support thrust load up to 4000 N.
- Mechanical seal with sand protection.
- Removable cable connector.
- Maximum immersion depth: 150 m.
- Maximum number of starts per hour at regular intervals: 30 for direct start.
- Maximum allowable voltage fluctuations over the rated voltage:  $220\text{ V} \pm 10\%$ .

### MODELS

- Single-phase:  
from 0,25 to 1,5 kW, 220 V, 50 Hz.

### OPTIONAL FEATURES

- Different voltage and frequency.
- Different materials.



### IDENTIFICATION CODE

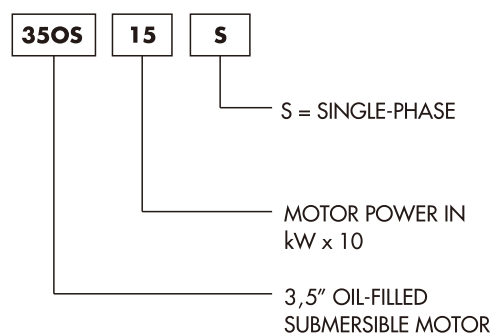

### EXAMPLE OF MOTOR TYPE

35OS15S

3,5" oil-filled submersible motor, single-phase,  
1,5kW (2 Hp).

## 350S SERIES MOTOR CROSS SECTION AND TABLE OF MATERIAL

## DIMENSIONS AND WEIGHTS AT 50 Hz

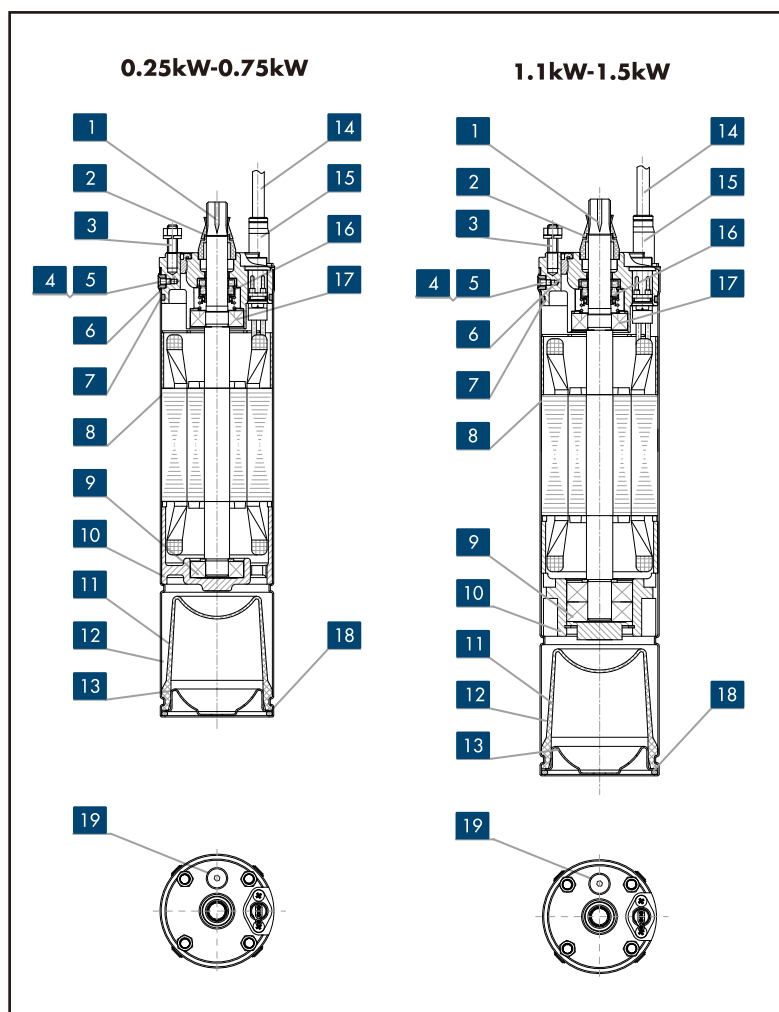

REF.N.	PART	MATERIAL	STANDARD
1	Shaft extension	Stainless steel	AISI 420
2	Sand protection	NBR	-----
3	Double ends studs	Stainless steel	AISI 304
4	Pin	Stainless steel	AISI 304
5	Screw	Stainless steel	AISI 304
6	Upper support	Cast iron & Stainless steel	ASTM 200A & AISI304
7	O-ring	NBR	-----
8	Motor shell	Stainless steel	AISI 304
9	Angular bearing	-----	-----
10	Lower support	Cast iron	ASTM 200A
11	Compensation bellow	NBR	-----
12	Cooling liquid	Non toxic oil	-----
13	Lower protection	Stainless steel	AISI 304
14	Cable	-----	-----
15	Cable connector sleeve	Stainless steel	AISI 304
16	Mechanical seal	Carbon/Ceramic	-----
17	Ball bearing	-----	-----
18	Snap ring	Stainless steel	AISI 304
19	Filling screw	Stainless steel	AISI 304

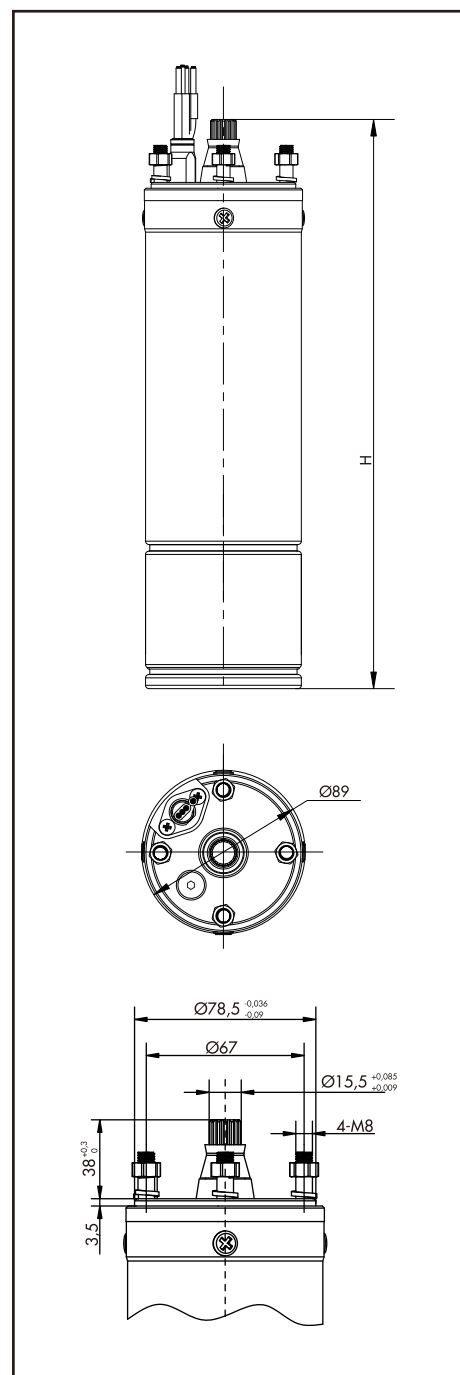

MOTOR TYPE	POWER		H mm	WEIGHT kg
	kW	Hp		
350S02S	0,25	0,33	386	6,5
350S03S	0,37	0,5	401	7,3
350S05S	0,55	0,75	421	8
350S07S	0,75	1	446	9
350S11S	1,1	1,5	505	11
350S15S	1,5	2	560	13